

Title:	RN DS-K1T671 Series MinMoe Terminal	Version:	v3.1.0	Date:	042120
Product:	DS-K1T671 MinMoe Terminal	Build:	200420	Page:	1 of 5
Action Required:	None, Information Only				

■ Summary

Firmware has been upgraded to add new features, fix bugs, enhance product quality, and meet customers' requirements.

Device Model: DS-K1T671M/MF Naming Rule: M for M1 card F for fingerprint	Firmware Version	ARM: ACS_671_AI3_EN_GM_V3.1.0_build200420 MCU: ACS_DS-K1T671_ST1_GML_GM_V1.0.1_build200331
	SDK	HCNetSDKV6.1.0.25_build20190718_Win32_EN HCEhomeSDKV2.2.1.1_build20190410_win32
	iVMS-4200 Client Version	iVMS-4200 AC(V1.0.3.11_E).exe iVMS-4200 V3.2.0.10.exe

■ New Features

- Increased face (user) capacity

	Face	Card (M1)	Fingerprint	Event
DS-K1T671 Series	6,000 (Previously 5,000)	6,000	5,000 (F model)	50,000

- Multiple Languages:** English, Thai, Indonesian, Spanish, Russian, and Arabic

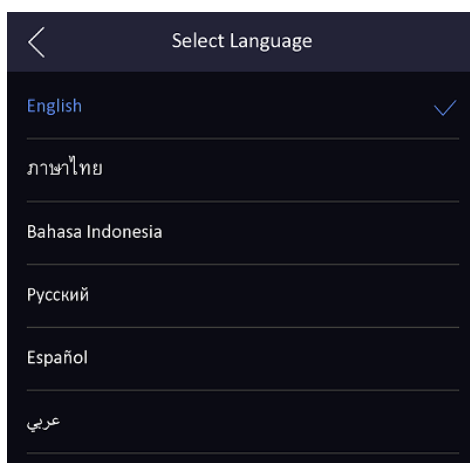

Title:	RN DS-K1T671 Series MinMoe Terminal	Version:	v3.1.0	Date:	042120
Product:	DS-K1T671 MinMoe Terminal	Build:	200420	Page:	2 of 5
Action Required:	None, Information Only				

- Log in and configure device in Web client via Web browser to realize person management, parameter configuration, log search, and system maintenance.

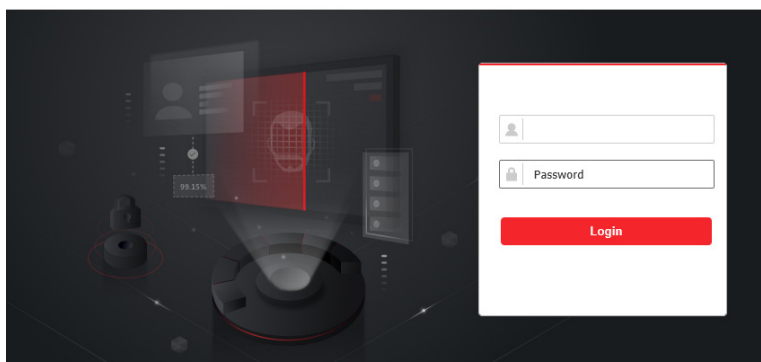

- Supports encryption (4 to 6 characters, optional) for USB import and export data.

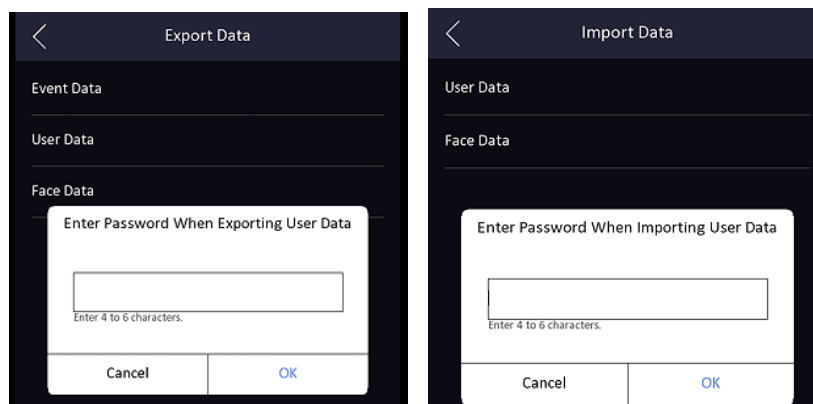

- Supports ISUP 5.0 (EHome 5.0) protocol to manage devices located in different locations.

Title:	RN DS-K1T671 Series MinMoe Terminal	Version:	v3.1.0	Date:	042120
Product:	DS-K1T671 MinMoe Terminal	Build:	200420	Page:	3 of 5
Action Required:	None, Information Only				

The screenshot shows the 'Configuration' tab in the Hikvision interface. The left sidebar lists various settings categories: Local, System, Network, Basic Settings, Advanced, Video/Audio, Video Intercom, Access Control, Image, Smart, and Notice Publication. The 'Advanced' category is selected. The main panel displays the 'Platform Access' settings for 'Wi-Fi'. The 'Platform Access Mode' is set to 'Ehome'. The 'Enable' checkbox is checked. The 'Protocol Version' is set to 'v5.0'. The 'Server Address' is '0.0.0.0', the 'Port' is '0', the 'Device ID' is empty, and the 'EHome Key' is empty. The 'Status' is set to 'Offline'. A red 'Save' button is at the bottom right.

- Imports background pictures, and the device will play pictures during standby status.

The screenshot shows the 'Notice Publication' settings in the Hikvision interface. The left sidebar is the same as the previous screenshot, with 'Notice Publication' selected. The main panel shows the 'Notice Publication' settings. The 'Sleep' checkbox is checked. The 'Sleep after' time is set to '60' seconds. The 'Customize Screen Saver' checkbox is unchecked. The 'Screen Saver Picture' section has a note: 'Only JPEG format is allowed. Up to 8 pictures can be added.' Below this is a large empty box with a '+' icon. An 'Upload' button is below the box. The 'Slide Show Interval' is set to '1' second. A red 'Save' button is at the bottom right.

- Self-defined screen display info (user ID, name, and face picture) for authentication result.

Title:	RN DS-K1T671 Series MinMoe Terminal	Version:	v3.1.0	Date:	042120
Product:	DS-K1T671 MinMoe Terminal	Build:	200420	Page:	4 of 5
Action Required:	None, Information Only				

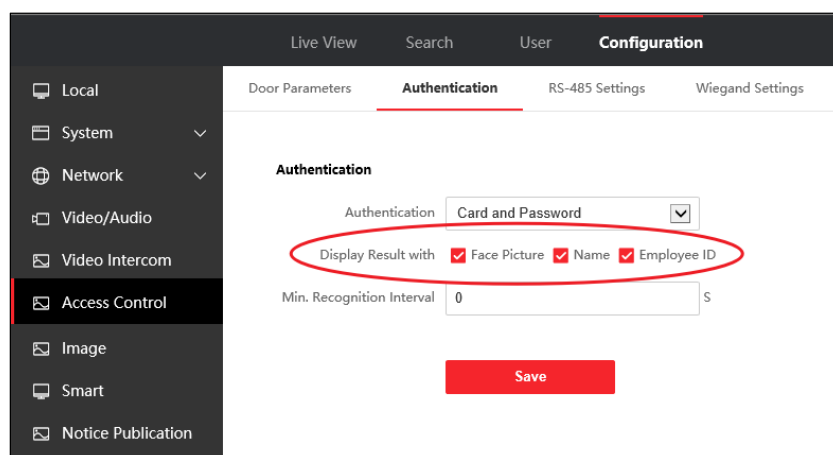

- Self-defined shortcut key (QR Code, Call, and Password) on main interface, with which a user can select to call rooms, call Management Center, or a specified room number after pressing the call button on the main screen. Can call a specified room no. by default.

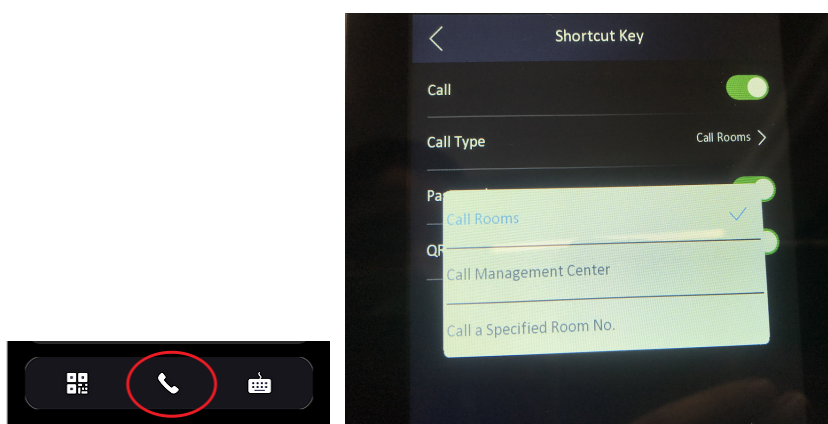

- Status bar shows device status in real time, including network status, deployment/arm status, and Hik-Connect server connection status.



Title:	RN DS-K1T671 Series MinMoe Terminal	Version:	v3.1.0	Date:	042120
Product:	DS-K1T671 MinMoe Terminal	Build:	200420	Page:	5 of 5
Action Required:	None, Information Only				

■ Modified Features

- Optimized new UI style

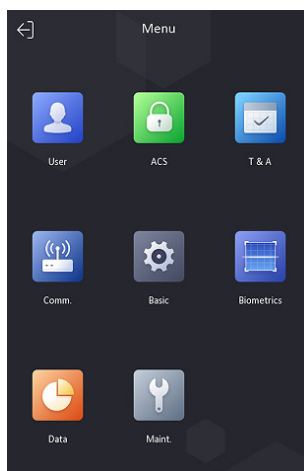

■ Customer Impact and Recommended Action

This update refers to function/compatibility improvements and will take effect automatically after the Date of Change. We are very sorry for any inconvenience of use-habit changes caused by this action.

For any questions and request for this firmware, please contact our local technical support team.

■ Remarks

- Hikvision reserves the right to change, alter or withdraw the above notification without prior notice.
- Hikvision reserves the right to change, alter, or withdraw the above notification without prior notice.
- Product design and specifications are subject to change without prior notice.
- The Hikvision firmware may contain errors known as errata which may cause the product to deviate from published specifications. Current characterized errata are available on request.
- Hikvision is not liable for any typing or printing errors.